

Gyplyner UNIVERSAL - Double Boarded System @ 600mm centres

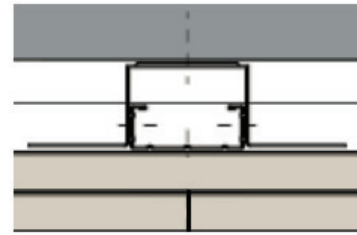

Consumption Rate Criteria

Stud Type	Gypframe GL1 Stud
Stud Spacing	600mm centres
Lining Height	3000mm
Lining Area	100m ²

Component	Total Quantity per 100m ²
Gyproc Plasterboard	200 m ²
Gypframe GL1 Stud	167 m
Gypframe GA1 Angle	67 m
Gypframe GLB85 / GLB135 Bracket	220 pieces
Gypframe GFS1 Fixing Strap	35 m
Gyproc Drywall Screws (Inner Layer)	900 pieces
Gyproc Drywall Screws (Outer Layer)	1240 pieces
Gyproc Wafer Head Screws	496 pieces
Gyproc Sealant	4 tubes
Isover APR Glass Wool insulation supplied by KIMMCO (If required)	100 m ²
Gyproc Joint Tape	130 m
GypFine Jointing Compound	28 kg
Deflection head (plasterboard strips, Gyproc FireStrip and mineral wool insulation)	Refer deflection head guidance

For General Consideration

- The above quantity take-off to be read in conjunction with the Gyproc proposal for the project and the Gyproc White Book available at www.gyproc.ae
- Where partition heights extend beyond the stud length, consider one additional Gyplyner bracket for each stud splicing
- Gypframe Channel requirements may differ depending on partition length and height combinations within 100m² area. Refer to the Gyproc White Book for details regarding the appropriate use of Gypframe Channel based on the actual lining height
- Consumption rates estimated from typical partition dimensions of 3000mm high and 100m² total area (straight partition without any corners). The material requirement have been based on the standard Gyproc System proposed and does not include wastage, additional studs where T-junctions, abutments and splayed angles, bulk filling to the base where boards have been lifted or raised slightly off the floor.
- It is the responsibility of the ordering authority to check the above quantities against final drawings, BOQ and site conditions before placing material orders. Gyproc cannot be held liable for actual quantities required for the project.

Gyplyner UNIVERSAL - Double Boarded System @ 400mm centres



Consumption Rate Criteria

Stud Type	Gypframe GL1 Stud
Stud Spacing	400mm centres
Lining Height	3000mm
Lining Area	100m ²

Component	Total Quantity per 100m ²
Gyproc Plasterboard	200 m ²
Gypframe GL1 Stud	255 m
Gypframe GA1 Angle	67 m
Gypframe GLB85 / GLB135 Bracket	420 pieces
Gypframe GFS1 Fixing Strap	35 m
Gyproc Drywall Screws (Inner Layer)	955 pieces
Gyproc Drywall Screws (Outer Layer)	1460 pieces
Gyproc Wafer Head Screws	924 pieces
Gyproc Sealant	4 tubes
Isover APR Glass Wool insulation supplied by KIMMCO (If required)	100 m ²
Gyproc Joint Tape	130 m
GypFine Jointing Compound	28 kg
Deflection head (plasterboard strips, Gyproc FireStrip and mineral wool insulation)	Refer deflection head guidance

For General Consideration

- The above quantity take-off to be read in conjunction with the Gyproc proposal for the project and the Gyproc White Book available at www.gyproc.ae
- Where partition heights extend beyond the stud length, consider one additional Gyplyner bracket for each stud splicing
- Gypframe Channel requirements may differ depending on partition length and height combinations within 100m² area. Refer to the Gyproc White Book for details regarding the appropriate use of Gypframe Channel based on the actual lining height
- Consumption rates estimated from typical partition dimensions of 3000mm high and 100m² total area (straight partition without any corners). The material requirement have been based on the standard Gyproc System proposed and does not include wastage, additional studs where T-junctions, abutments and splayed angles, bulk filling to the base where boards have been lifted or raised slightly off the floor.
- It is the responsibility of the ordering authority to check the above quantities against final drawings, BOQ and site conditions before placing material orders. Gyproc cannot be held liable for actual quantities required for the project.

GypLyner iWL - Double Boarded System @ 300mm centres



Consumption Rate Criteria

Stud Type	Gypframe GL1 Stud
Stud Spacing	300mm centres
Lining Height	3000mm
Lining Area	100m ²

Component	Total Quantity per 100m ²
Gyproc Plasterboard	100 m ²
Gypframe GL1 Stud	339 m
Gypframe GA1 Angle	67 m
Gypframe GLB85 / GLB135 Bracket	555 pieces
Gypframe GFS1 Fixing Strap (as required)	35 m
Gyproc Drywall Screws (Inner Layer)	1010 pieces
Gyproc Drywall Screws (Outer Layer)	1680 pieces
Gyproc Wafer Head Screws	1222 pieces
Gyproc Sealant	4 tubes
Isover APR Glass Wool insulation supplied by KIMMCO (If required)	100 m ²
Gyproc Joint Tape (as required)	130 m
GypFine Jointing Compound	28 kg
Deflection head (plasterboard strips, Gyproc FireStrip and mineral wool insulation)	Refer deflection head guidance

For General Consideration

- The above quantity take-off to be read in conjunction with the Gyproc proposal for the project and the Gyproc White Book available at www.gyproc.ae
- Where partition heights extend beyond the stud length, consider one additional GypLyner bracket for each stud splicing
- Gypframe Channel requirements may differ depending on partition length and height combinations within 100m² area. Refer to the Gyproc White Book for details regarding the appropriate use of Gypframe Channel based on the actual lining height
- Consumption rates estimated from typical partition dimensions of 3000mm high and 100m² total area (straight partition without any corners). The material requirement have been based on the standard Gyproc System proposed and does not include wastage, additional studs where T-junctions, abutments and splayed angles, bulk filling to the base where boards have been lifted or raised slightly off the floor.
- It is the responsibility of the ordering authority to check the above quantities against final drawings, BOQ and site conditions before placing material orders. Gyproc cannot be held liable for actual quantities required for the project.