

GypLyner UNIVERSAL ceilings



Concealed ceiling
lining system

St. Regis Residences
Amman, Jordan



GypLyner UNIVERSAL ceilings

GypLyner UNIVERSAL ceilings is a general purpose ceiling lining system suitable for most internal applications. It is used in all types of buildings from residential properties to large commercial developments and is equally suited to both new-build and refurbishment.



Key Benefits



A versatile system utilising same components for wall or ceiling lining



Commonality of ceiling and wall lining components



Suitable for all concrete soffits



Ceiling void accommodates small service routings



Minimum loss in room space with as little as 25mm cavity



Compatible with wide range of Gyproc, Glasroc, Gypstone and Rigitone boards



Eligible for the SpecSure warranty from Gyproc

System components

Gypframe metal components



Gypframe GL1 Lining Channel
Main support channel to receive fixing of board



Gypframe Shadow Angle
A primed, pre-formed aluminium trim for design effects on Gyproc MF ceilings



Gypframe GA1 Steel Angle
Primarily used as a perimeter wall angle



Gypframe GLB85 Bracket
For connecting the GL1 Lining Channel to the soffit with a maximum of 85mm cavity depth



Gypframe GLB135 Bracket
For connecting the GL1 Lining Channel to the soffit with a maximum of 135mm cavity depth

Board products



Gyproc Regular^{1, 2, 3}
(9, 12.5, 15mm)
Standard gypsum plasterboard



Aquadroc FC
(12, 15mm)
Fibre cement board with excellent moisture resistant characteristics and mechanical strength



Gyproc FireStop^{1, 2, 3}
(12.5, 15mm)
Gypsum plasterboard with fire resistant additives



Glasroc X²
(12.5mm)
Glasroc X is a high performance board with a glass-mat liner on both surfaces and a mold & moisture resistant (M2TECH) gypsum core



Gyproc SoundBloc^{1, 2}
(12.5, 15mm)
Gypsum plasterboard with a high density core for enhanced sound insulation performance



Gyptone BIG board
A range of perforated acoustic plasterboard with geometric set pattern with Activ'Air functionality



Gyproc Habito²
(12.5mm, 15mm)
Next generation plasterboard which consists of a specially reinforced gypsum core designed for high strength and fixing capability



Rigitone board
A range of perforated acoustic plasterboard with set or random design for continuous, jointless and borderless pattern with Activ'Air functionality

¹ Moisture resistant (MR) versions of the above boards are specified in intermittent wet use areas, e.g. shower cubicles

² Available with Activ'Air technology

³ Available with M2TECH technology



System components (continued)

Fixing products



Gyproc Drywall Screws

Corrosion resistant self-tapping steel screws for fixing board to metal framing less than 0.8mm thick



Gyproc Waferhead Screws

Corrosion resistant self-tapping steel screws for fixing metal to metal framing less than 0.8mm thick



Gyproc Habito Screws

Corrosion resistant self-tapping screw with counter sunk cross heads specifically used for fixing Gyproc Habito plasterboard to Gypframe framework



Gyproc Waferhead Jack-Point Screws

Corrosion resistant self-drilling steel screws for fixing metal to metal framing 0.8mm thick or greater and



Gyproc Jack-Point Screws

Corrosion resistant self-drilling steel screws for fixing boards to Gypframe metal framing 0.8mm thick or greater



Gyproc Hammer Fix

Corrosion resistant nail, screw engaged in a nylon plug, suitable for fixing non fire rated partition systems and ceiling perimeters into masonry



Gyproc Wedge Anchor

Corrosion resistant anchor used for fixing fire rated partition and ceiling systems into masonry

Plasterboard accessories



Gyproc Jointing Compound

Air-drying, asbestos free, ready mixed compound for filling and finishing plasterboard joints and corner beads



Gyproc Paper Tape

Designed for reinforcing flat joints when finishing plasterboard joints providing improved resistance against cracking



Gyproc Sealant

Used for sealing air paths to reduce air-leakage and optimise sound insulation performance



Glasroc X Tape

Suitable for internal and semi-exposed applications when used in conjunction with Glasroc X, MR and M2TECH range of boards

Corners



Levelline Flex

Adjustable corner reinforcement that flexes to any angle and gives high levels of impact protection



Gyproc Drywall Metal Edge Bead

A galvanised steel channel used to protect plasterboard edges and to form a defined edge commonly used around window reveals



Gyproc Drywall Corner Bead

Provides corner reinforcement and protection to plasterboards and plasters



Gyproc Metal Corner Tape

High quality paper joint tape strengthened with two corrosion-resistant galvanised steel strips for the finishing of internal and external angles in drywall construction

Installation overview



Gypframe GA1 Perimeter Angle is fixed to the wall at maximum 600mm centres using Gyproc Hammer Fix Anchor.



Gypframe GLB85 or GLB135 Brackets are fixed to the soffit at the required centres using Gyproc Wedge Anchor.



Gypframe GL1 Lining Channels are located into the perimeter track and each leg of the Gypframe GLB85 or GLB135 Brackets are screw-fixed to the Gypframe GL1 Lining Channels with Gyproc Waferhead Screws.



The protruding legs of each bracket are bent to sit back from the channel face. Additional angle or supplementary framing is installed if required to support fixtures.



Gyproc Boards are fixed to the Gypframe GL1 Lining Channels to form single or multi-layer linings as specified.

Construction details

1

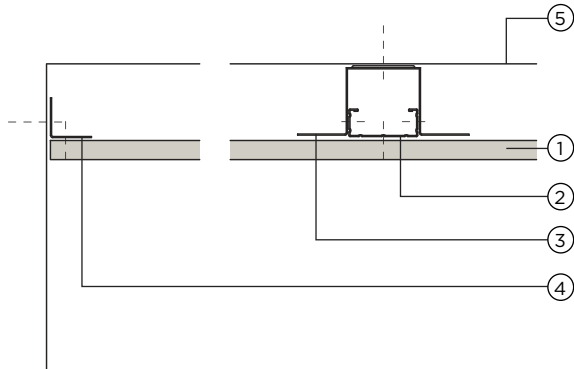

Perimeter detail parallel to Gypframe GL1 Lining Channel

2

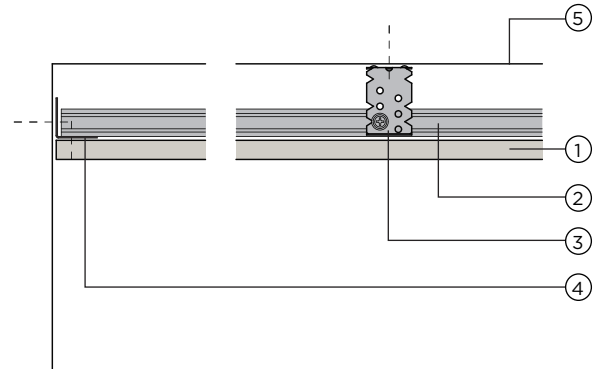

Perimeter detail perpendicular to Gypframe GL1 Lining Channel

3

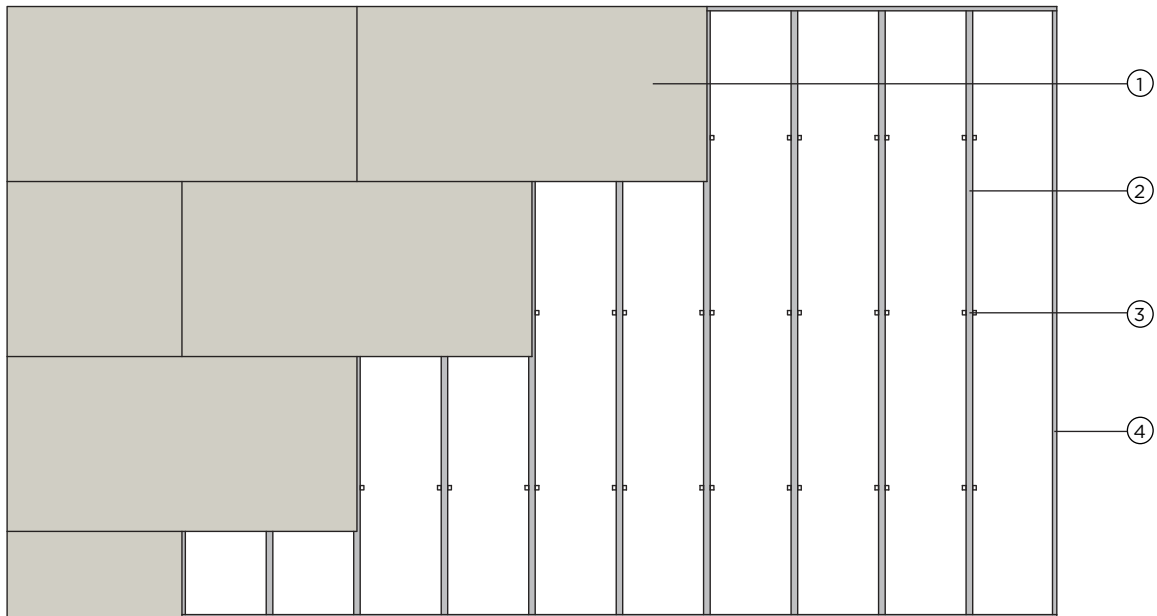

Reflected ceiling plan

- | | |
|---|-----------------------------|
| 1. Gyproc plasterboard | 4. Gypframe GA1 Steel Angle |
| 2. Gypframe GL1 Lining Channel (at 400mm centres) | 5. Concrete Soffit |
| 3. Gypframe GLB85/GLB135 Bracket (at 1200mm centres for single layer application) | |