

Gyptone GRID acoustic ceilings

Demountable suspended
grid ceiling system

Masdar Neighbourhood
One Residence
Abu Dhabi



Gyptone GRID acoustic ceilings

Gyptone GRID is a lightweight ceiling system available in concealed or exposed grid. Gyptone tiles are pre-finished in white and are available in a wide range of perforations.



0.60 - 0.75

NRC



0.65 - 0.80

α_w

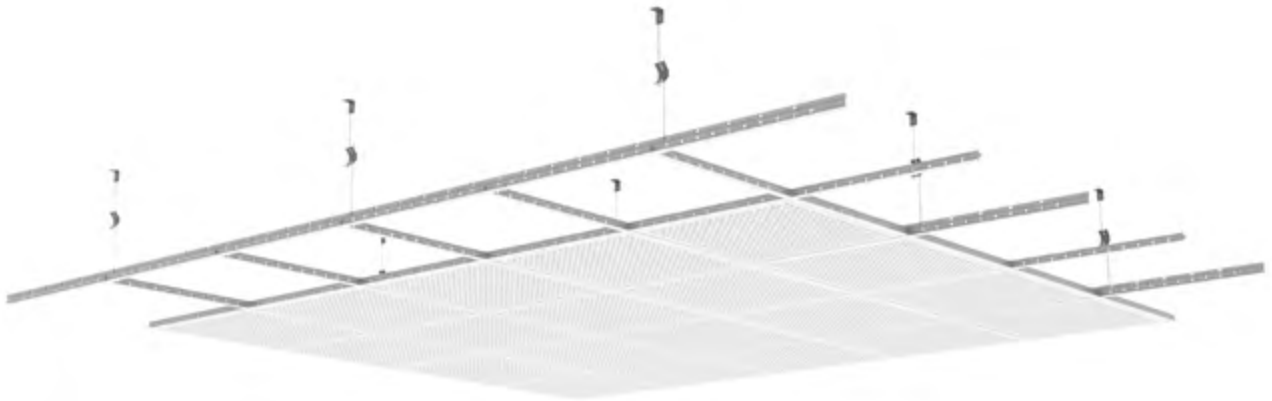

Key Benefits



Good Acoustics - Absorption and diffusion up to α_w 0.80 - NRC 0.75



Hassle-free access to the ceiling cavity



Improves indoor air quality



Fast and easy installation - Simple and easy to cut and adapt



Easy cleaning and maintenance



Robust design - high load-bearing capacity of up to 3kg per tile



Eligible for the SpecSure warranty from Gyproc

System components

Gypframe T Grids metal products



Gypframe 15mm T Grid Sections
(15mm Main T 3600mm /
15mm Cross T 600mm /
15mm Cross T 1200mm)

Galvanised steel sections with a 15mm width that provide the main grid components of the exposed suspended ceiling system. They are suitable to receive Edge A and Edge E15 ceiling tiles



Gypframe 24mm T Grid Sections
(24mm Main T 3600mm /
24mm Cross T 600mm /
24mm Cross T 1200mm)

Galvanised steel sections with a 24mm width that provide the main grid components of the exposed suspended ceiling system. They are suitable to receive Edge A and Edge E24 ceiling tiles



Gypframe T Wall Angle
(3600mm)

Steel perimeter track screw fixed to the wall to secure the suspended ceiling system



Gypframe T Shadow Angle
(3600mm)

Steel perimeter track screw fixed to the wall to secure the suspended ceiling system. The Shadow Angle provides a stepped design border where a premium finish is required



Gypframe T Adjustable Hangers
(Adjustable Clips / 3mm Hanger Rod:
750mm / 1000mm / 1500mm)

High-strength adjustable steel hangers for suspension of Gypframe T Grid system. It consists of two identical Hanger Rods (top and bottom) connected by an adjustable clip



Gypframe Soffit Cleat with Nut & Bolt

Cleat for suspending Gypframe T Adjustable Hangers from soffit

Gyptone Edge D2 Cross-Lock Unipro grid system

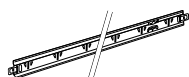

Main beam unipro
L: T-24 3600 mm

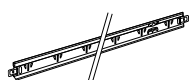

Cross profile unipro
L: T-24 3600 mm



Wall angle
L: 3000 mm



Cross Lock connector

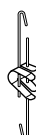

Adjustable Hangers
for length between 90-1500 mm

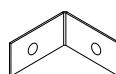

Connecting bracket



Wall springs

System components (continued)

Gyptone Tiles



Gyptone Point 11

Pre-finished white tile with 6.5mm diameter round perforations at 15mm centres, giving a total perforated area of 12%



Gyptone Line 4

Pre-finished white tile with 6mm x 95mm line perforations, giving a total perforated area of 18%



Gyptone Quattro 20

Pre-finished white tile with 9mm square perforation at 19.5mm centres, giving a total perforated area of 18%



Gyptone Quattro 50

Pre-finished white tile with 12mm square perforation at 25mm centres, giving a total perforated area of 18%



Gyptone Quattro 70

Pre-finished white tile with 3mm square perforation at 8.33mm centres, giving a total perforated area of 11%



Gyptone Sixto 60

Pre-finished white tile with 11mm hexagonal perforations at 20mm centres, giving a total perforated area of 17%



Edge Details



A
T15/T24



E24
24mm T sections

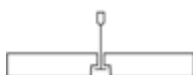

E15
15mm T sections

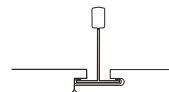

D2
T24 - D2

Fixing products



Gyproc Wedge Anchor

Corrosion resistant anchor used for fixing fire rated partition and ceiling systems into masonry



Gyproc Hammer Fix

Corrosion resistant nail, screw engaged in a nylon plug, suitable for fixing non fire rated partition systems and ceiling perimeters into masonry

Insulation products



ISOVER Eco Acoustic Partition Roll (APR) (75mm)*

Non-combustible glass mineral wool roll for sound insulation in partitions, linings and ceiling systems

Minimum density: 16 kg/m³

* Available in other thickness and density

Installation overview



The Gypframe T Wall or Shadow Angle is mounted with a Gyproc Hammer Fix or a Gyproc Drywall Screw as suitable at maximum 300mm centres.

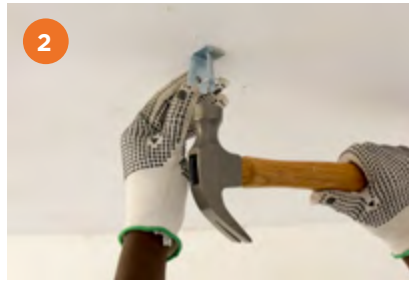

Secure Gypframe Soffit Cleat using Gyproc Wedge Anchor.



Gypframe T Adjustable Hangers are fixed into the Gypframe soffit cleat at 1200 mm centres.



Position the first Gypframe Main T max. 600 mm from the wall. First Gypframe Adjustable Hanger in Gypframe Main T max. 400 mm from the wall. The other hangers are at per max. 1200mm.

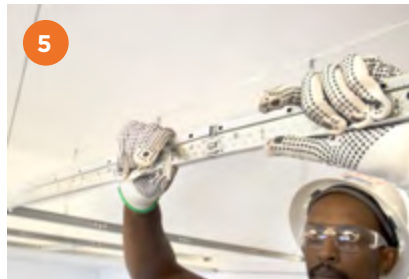

Extend the Gypframe Main T by pushing them together until they click.



Gypframe Cross T is mounted at 600mm centres. The length of the Gypframe Cross T closest to the wall is adjusted. The grid system is adjusted to the accurate height.



When placing the Gyptone tiles, use cotton gloves. Lift the tiles square through the grid system and lower it onto its place. Please note that all Gyptone tiles are directional (see the installation method inserted in the Gyptone package). All installations should be finished before mounting the tiles.



The perimeter tiles against the wall can be cut with either a knife or with a saw. When using a saw, cut the tile from the front side of the tile. When using a knife cut the front side paper liner first.

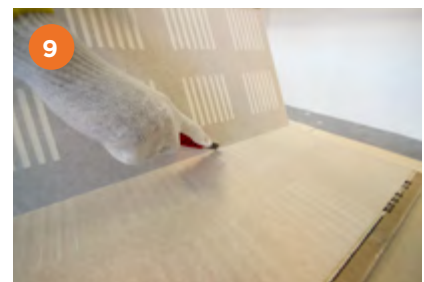

Once the front side paper liner is cut, break the tile and cut through the backside paper liner. The perimeter tiles should not be cut with an undersize of more than max. 5mm.

Table 1 - Gyptone sound absorption performance based on ISO 354

1

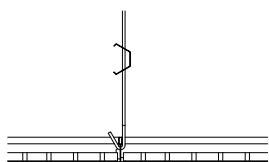

Gyptone ceiling tiles beneath basic floor.
Ceiling tiles linings as in table.

2

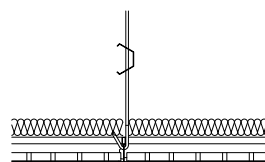

Gyptone ceiling suspended beneath basic floor, with ISOVER
Eco APR in the cavity. Ceiling tiles linings as in table.

Detail	Tile type	Insulation mm	Plenum depth mm	Sound absorption	
				NRC	α_w
1	Point 11	-	200	0.65	0.65
2	Point 11	75	300	0.70	0.75
1	Quattro 70	-	200	0.60	0.65
2	Quattro 70	75	300	0.60	0.65
1	Quattro 50	-	200	0.70	0.70
2	Quattro 50	75	300	0.75	0.75
1	Quattro 20	-	200	0.70	0.75
2	Quattro 20	75	300	0.75	0.80
1	Line 4	-	200	0.70	0.65
2	Line 4	75	300	0.70	0.70
1	Sixto 60	-	200	0.65	0.75
2	Sixto 60	75	300	0.75	0.80

Design

Product description

Edge A

Gyptone edge A is a pre-painted, removable, acoustic suspended ceiling tile mounted in an exposed grid system (T15 or T24). The visible width of the grid system is 15 or 24mm. Gyptone edge A is a fully demountable ceiling so it provides good opportunities for inspection in the cavity above the ceiling. Gyptone edge A is available with perforated and non-perforated surface. Available in thickness of 10mm and 12.5mm with the tile size of 600x600mm.

Edge E15

Gyptone edge E15 is a pre-painted, removable, acoustic suspended ceiling tile mounted in a semi exposed grid system (T15). The visible width of the grid system is 15 mm. Gyptone edge E15 is a fully demountable ceiling so it provides good opportunities for inspection in the cavity above the ceiling. Gyptone edge E is available with perforated and non-perforated surface. Available in thickness of 10mm and 12.5mm with the tile size of 600x600mm.

Edge D2

Gyptone edge D2 is a pre-painted, acoustic suspended ceiling tile mounted in a concealed 24mm grid system. Gyptone edge D2 is a fully demountable ceiling. Gyptone edge D2 is available with perforated and non-perforated surface. Available in thickness of 12.5mm with the tile size of 600x600mm.

Plenum depth - T-grid system with adjustable hangers

To ensure an easy-going mounting of the tiles in the grid-system, the distance between the lower surface of the grids and the above element of building should be min. 100mm. The depth is measured without any Gyptone tiles and without attachment to the slab above the ceiling. The distance is from the top of the hanger, to the bottom of the painted grid system.

Surfaces

The tiles surface is painted from the factory. Each Gyptone tile is painted with the colour NCS0500, with a gloss value of 5-9 according to ISO 2813. Future treatment is to be executed with a short-haired roller as spray painting will impair the acoustic performance. The colour of the grid system is snow-white (close to RAL9016 or RAL9003).

Grid system

Edge A and E15

Gyptone edge A and edge E15 are installed on a Gypframe T grid system. The system is suspended using Gypframe T Adjustable Hangers. Gyptone edge A and edge E15 need to be installed in accordance with Gyproc installation guidance as well as the general specification of the project.

Edge D2

Gyptone edge D2 is installed in a Gyptone Cross-Lock Unipro system. The system is suspended using Gyptone Adjustable Hangers. Gyptone edge D2 needs to be installed in accordance with Gyproc installation guidance as well as the general specification of the project.

Fire classification

A2-s1, d0.

Loading

Edge A and E15

Maximum point load for each tile, with a deflection of max 2mm is 3kg. If higher loading is needed the fixtures need to be fixed to the slab above with dedicated suspensions.

Edge D2

Gyptone edge D2 has a maximum point load of 1kg for each tile, with a deflection of max. 2mm. If installations with a higher load is required, the fixtures should be fixed to the slab above with dedicated suspensions.

Stability - Relative Humidity

Gyptone tiles are to be installed and used in rooms with relative humidity not exceeding permanently 70% or temperatures exceeding 49 degrees celcius.

Weight

Edge A and E15 - 10mm thickness

Non perforated Gyptone edge E15 approx. 8 kg/m².

Perforated Gyptone edge E15 approx. 7 kg/m²

Edge A, E15 and D2 - 12.5mm thickness

Non perforated Gyptone D2 approx. 9 kg/m²

Perforated Gyptone D2 approx. 8 kg/m²

Maintenance

Gyptone ceiling tiles can be cleaned using a damp cloth or soft brush. Most standard mild detergents can be used. Tiles can be re-decorated if required using a suitable emulsion paint and a short-haired brush or roller (spray painting will impair sound absorption).

Gyptone tiles with Activ'Air

Though we don't notice them, impurities are often present in the air we breathe - emitted from furniture, carpets and building materials. Long-term exposure to these can potentially cause health problems and reduce general wellbeing.

Clean air, on the other hand, can speed up patient recovery in hospitals, reduce absence at work, and increase pupils' concentration at school.

Activ'Air is our latest innovative technology that improves indoor air quality by permanently removing formaldehyde circulating indoors. Formaldehyde concentration will be reduced by 70% when 1m² of Activ'Air is installed per m³.

Construction details - Edge A

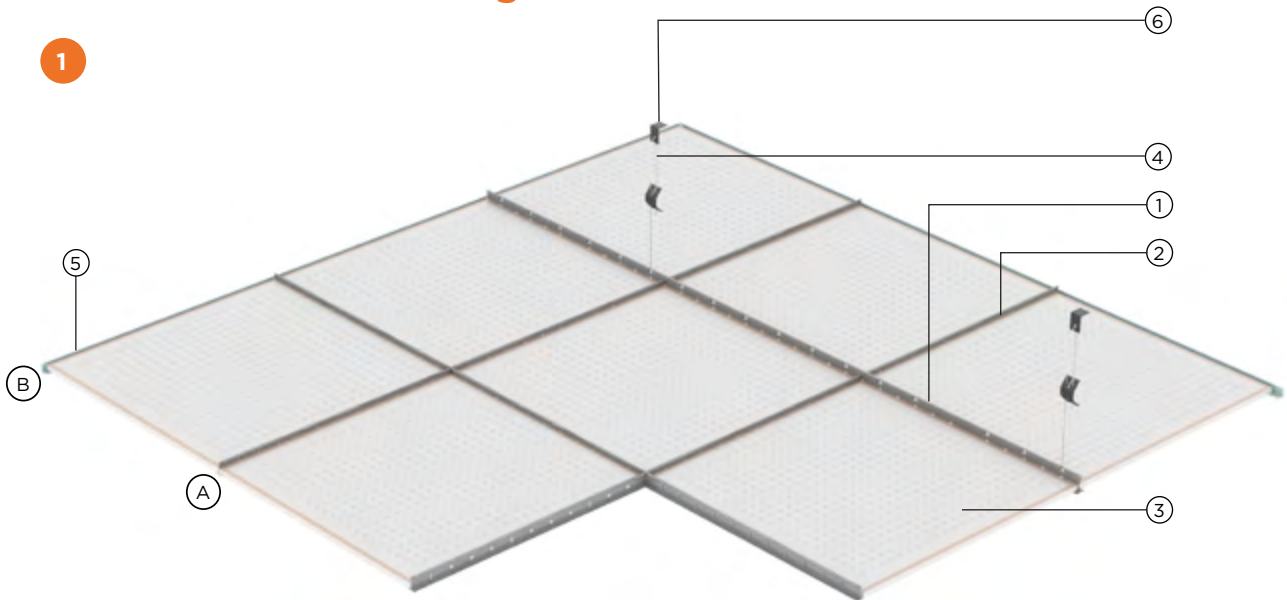

(A)

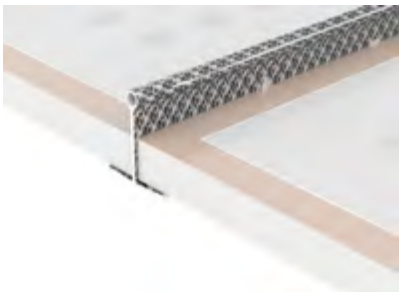

Supporting tile detail with Gyptone tile Edge A

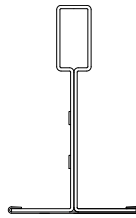

Gypframe Main T Grid Section

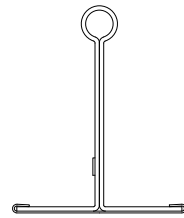

Gypframe Cross T Grid Section

(B) Option 1

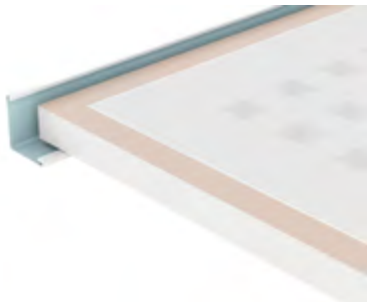

Perimeter detail with Gypframe T Wall Angle

(B) Option 2

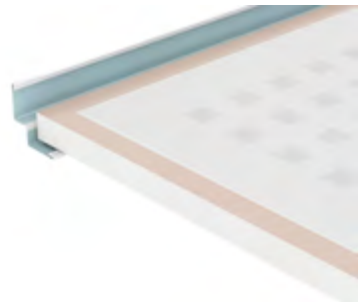

Perimeter detail with Gypframe T Shadow Angle

15mm and 24mm exposed lay-in grid with interlocking Main and Cross 'T's
- for Edge A tiles

1. Gypframe Main T Grid Section
2. Gypframe Cross T Grid Section
3. Gyptone tiles

4. Gypframe T Adjustable hanger
5. Gypframe T Wall Angle
6. Gypframe Soffit Cleat with Nut & Bolt

Construction details - Edge A (continued)

2

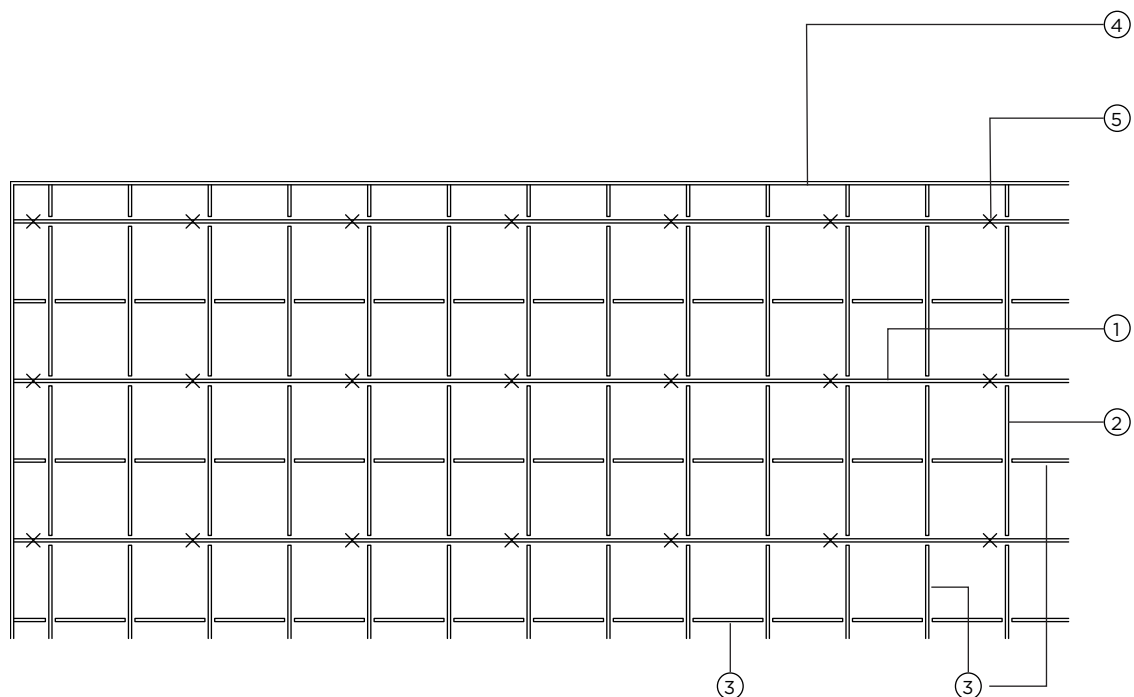

Gyptone tile Edge A
Grid layout 600x600

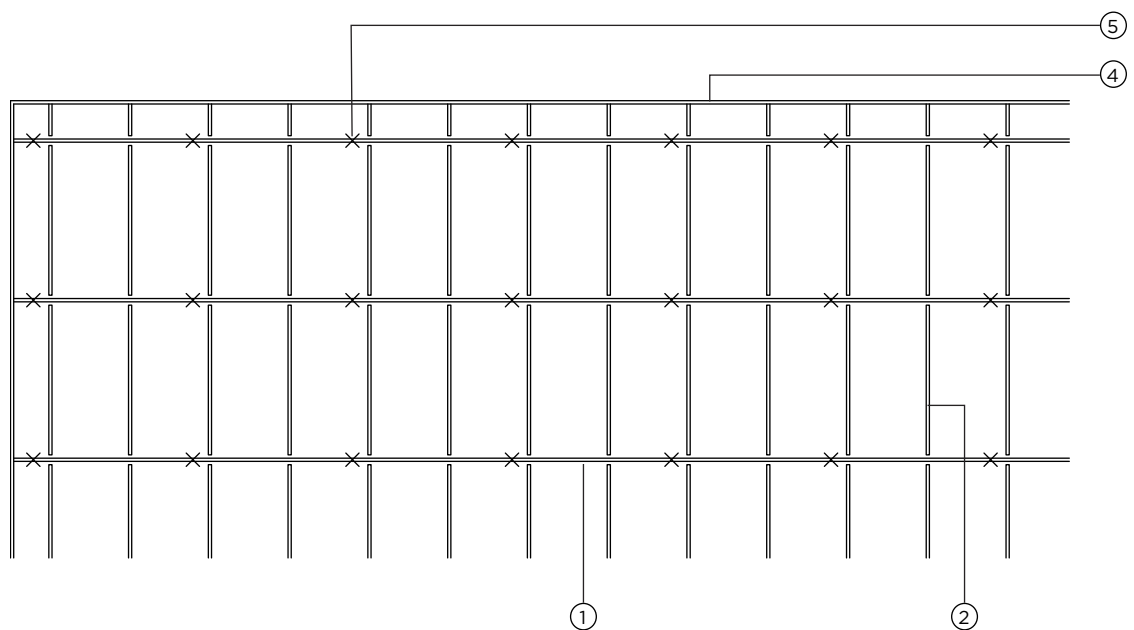

Gyptone tile Edge A
Grid layout 1200x600

- | | |
|---|--|
| 1. Gypframe Main T Grid Section | 4. Gypframe T Wall Angle / Gypframe T Shadow Angle |
| 2. Gypframe Cross T Grid Section 1200mm | 5. Gypframe T Adjustable Hanger shown as 'x' |
| 3. Gypframe Cross T Grid Section 600mm | |

NB These details are for illustrative purposes only. Precise details will vary according to the proprietary grid system used.

Construction details - Edge A (continued)

3

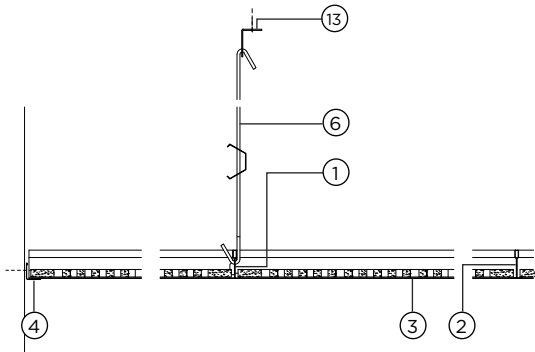

Perimeter detail with Gypframe T Wall Angle

4

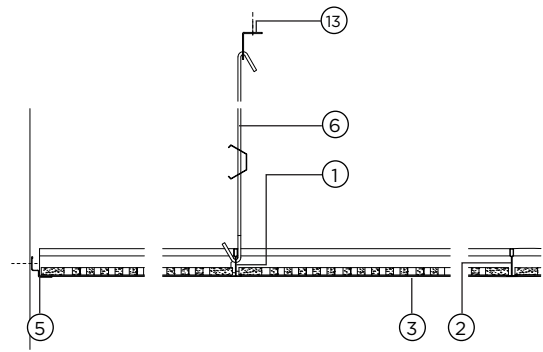

Perimeter detail with Gypframe T Shadow Angle

5

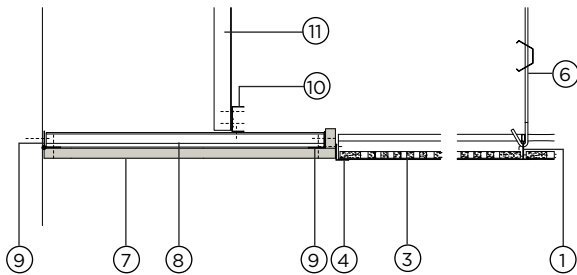

Lay-in grid abutting a plain plasterboard perimeter - perpendicular to MF5

6

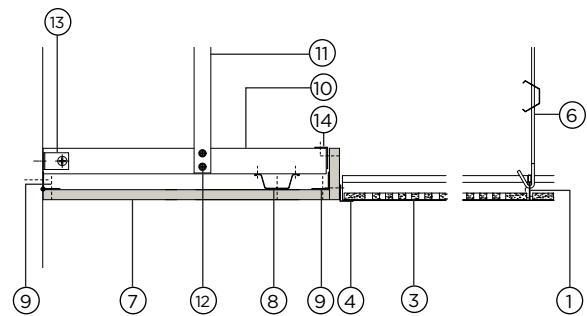

Lay-in grid abutting a plain plasterboard perimeter - parallel to MF5

1. Gypframe Main T Grid Section
2. Gypframe Cross T Grid Section
3. Gyptone tiles
4. Gypframe T Wall Angle
5. Gypframe T Shadow Angle
6. Gypframe T Adjustable Hanger
7. Gyproc plasterboard

8. Gypframe MF5 Ceiling Section
9. Gypframe GA1 Steel Angle
10. Gypframe MF7 Primary Support Channel
11. Gypframe GA1 Steel Angle hanger
12. Gyproc Waferhead Jack-Point Screw
13. Gypframe Soffit Cleat with Nut & Bolt
14. Gypframe GA3 Steel Angle

Construction details - Edge E15

7



A

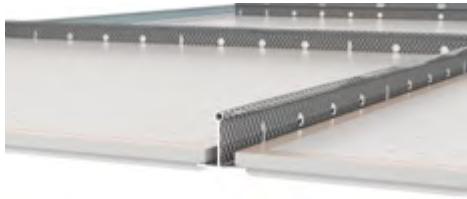

Supporting tile detail with Gyptone tile Edge E15

B



Perimeter detail with Gypframe T Shadow Angle

15mm and 24mm exposed lay-in grid with interlocking Main and Cross 'T's
- for Edge E15 tiles

1. Gypframe Main T Grid Section
2. Gypframe Cross T Grid Section
3. Gyptone tiles
4. Gypframe T Adjustable hanger
5. Gypframe T Shadow Angle
6. Gypframe Soffit Cleat with Nut & Bolt

Construction details - Edge E15 (continued)

8

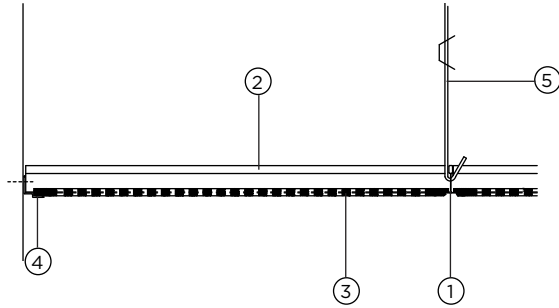

Perimeter detail with Gypframe T Shadow Angle

9

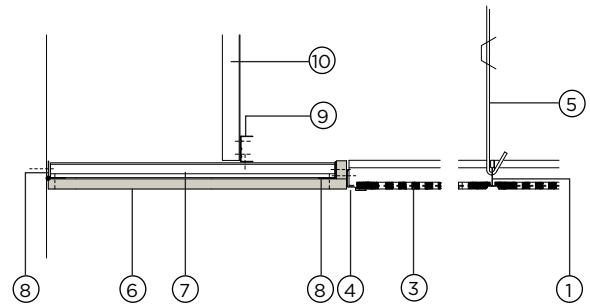

Lay-in grid abutting a plain plasterboard perimeter - perpendicular to MF5

10

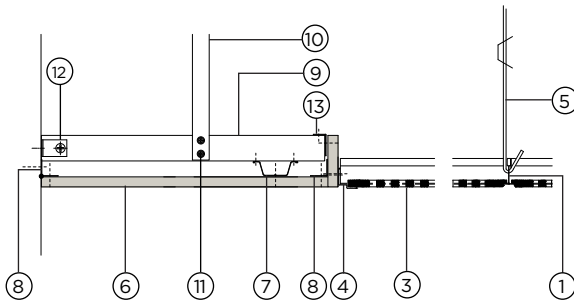

Lay-in grid abutting a plain plasterboard perimeter - parallel to MF5

1. Gypframe Main T Grid Section
2. Gypframe Cross T Grid Section
3. Gyptone tiles
4. Gypframe T Shadow Angle
5. Gypframe T Adjustable Hanger
6. Gyproc plasterboard
7. Gypframe MF5 Ceiling Section

8. Gypframe GA1 Steel Angle
9. Gypframe MF7 Primary Support Channel
10. Gypframe GA1 Steel Angle hanger
11. Gyproc Waferhead Jack-Point Screw
12. Gypframe Soffit Cleat with Nut & Bolt
13. Gypframe GA3 Steel Angle

Construction details - Edge D2

12

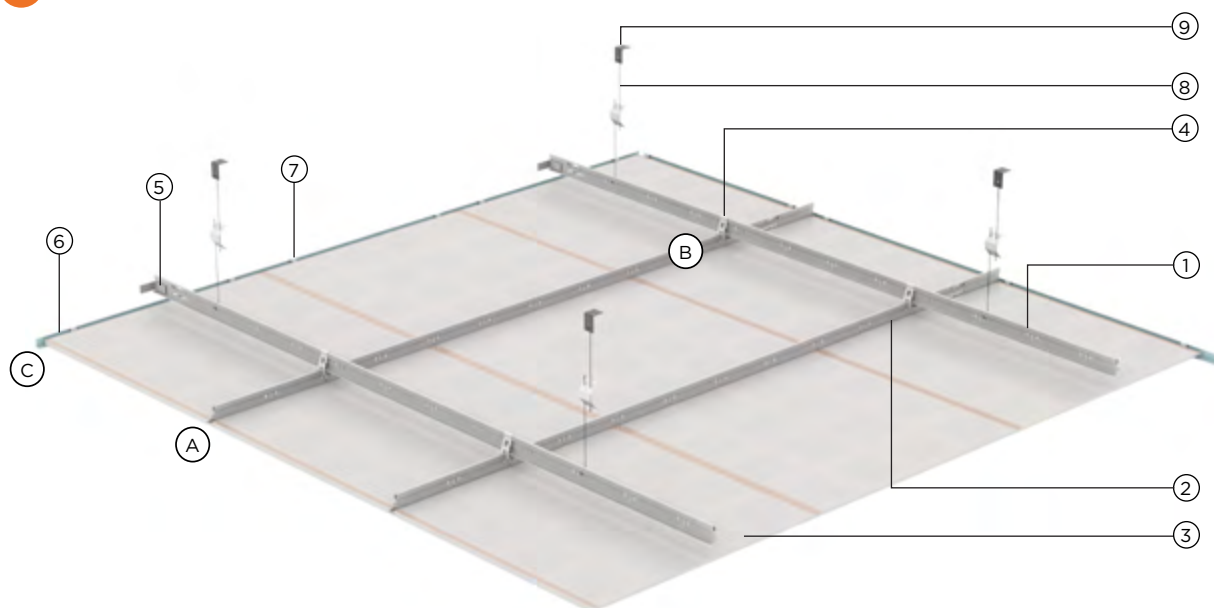

(A)

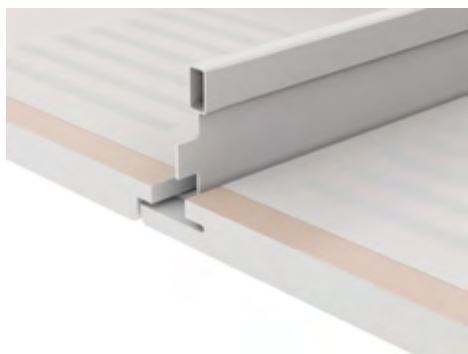

Supporting tile detail with
Gyptone tile Edge D2

(B)

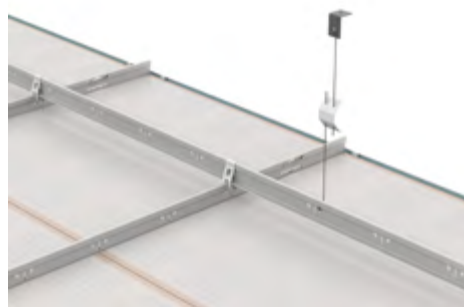

Main beam & Cross beam
profile junction detail

(C)

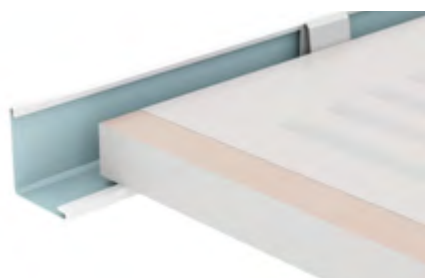

Perimeter detail with Gypframe T Wall Angle

Gyptone T24D2 concealed grid system consisting of interlocking Main 'T's and Cross 'T' spacers
- for concealed / demountable edge Gyptone D2 edge tiles

- | | |
|---------------------------------|--|
| 1. Gyptone Main Beam Unipro | 6. Gyptone Wall Angle |
| 2. Gyptone Cross Profile Unipro | 7. Gyptone Wall Spring |
| 3. Gyptone tiles | 8. Gyptone Adjustable Hanger |
| 4. Gyptone Cross-Lock Connector | 9. Gypframe Soffit Cleat with Nut & Bolt |
| 5. Gyptone Connecting Bracket | |

Construction details - Edge D2 (continued)

13

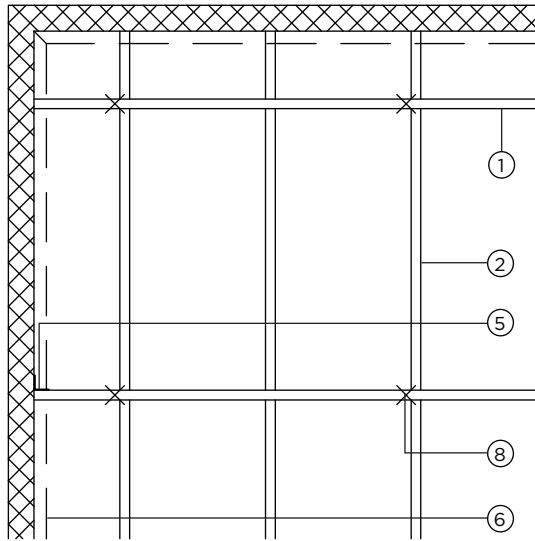

Gyptone grid - Tile edge D2
Grid layout - 600 x 600

14

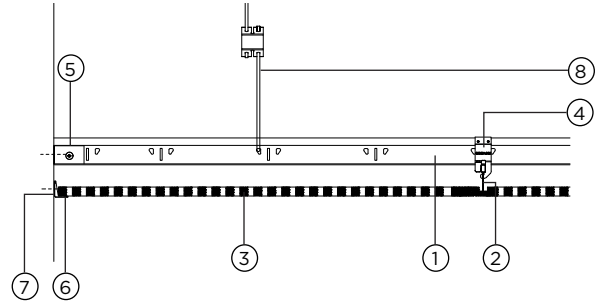

Perimeter detail with Gyptone Wall Angle

15

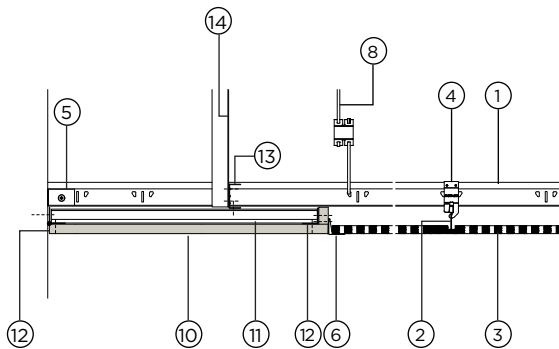

Lay-in grid abutting a plain plasterboard perimeter

16

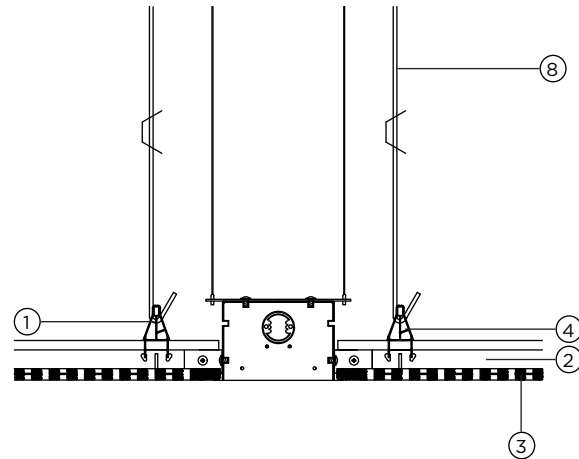

Light recess

1. Gyptone Main Beam Unipro
2. Gyptone Cross Profile Unipro
3. Gyptone tiles
4. Gyptone Cross-Lock Connector
5. Gyptone Connecting Bracket
6. Gyptone Wall Angle
7. Gyptone Wall spring

8. Gyptone Adjustable Hanger
9. Gypframe Soffit Cleat with Nut & Bolt
10. Gyproc plasterboard
11. Gypframe MF5 Ceiling Section
12. Gypframe GA1 Steel Angle
13. Gypframe MF7 Primary Support Channel
14. Gypframe GA1 Steel Angle Hanger