

GYPFRAME® T

Technical & Safety Datasheet



INTRODUCTION

Gypframe® T is a high-strength lay-in ceiling grid system suitable to receive Edge A, Edge E15 and Edge E24 ceiling tiles. Suitable for Gyptone and Ecophon tiles.

Standards:

ASTM C635 - Standard Specification for Manufacture, Performance, and Testing of Metal Suspension Systems for Acoustical Tile and Lay-in Panel Ceilings.

COMPONENTS

15mm T Grid Sections

Galvanised steel sections with a 15mm width precoated* cap that provide the main grid components of the exposed suspended ceiling system. They are suitable to receive Edge A and Edge E15 ceiling tiles.

	Length mm	Weight per piece kg
15mm Main T	3600	1.03
15mm Cross T	600	0.12
15mm Cross T	1200	0.25

24mm T Grid Sections

Galvanised steel sections with a 24mm width precoated* cap that provide the main grid components of the exposed suspended ceiling system. They are suitable to receive Edge A and Edge E24 ceiling tiles.

	Length mm	Weight per piece kg
24mm Main T	3600	1.12
24mm Cross T	600	0.14
24mm Cross T	1200	0.28

Wall and Shadow Angles

Precoated* galvanised steel perimeter track screw fixed to the wall to secure the suspended ceiling system. The Shadow Angle provides a stepped design border where a premium finish is required.

	Length mm	Weight per piece kg
Wall Angle	3600	0.55
Shadow Angle	3600	0.70

Adjustable Hangers

High-strength adjustable steel hangers for suspension of Gypframe T Grid system. It consists of two identical Hanger Rods (top and bottom) connected by an adjustable clip.

	Length mm	Weight per piece kg
Adjustable Clip	N/A	0.01
3mm Hanger Rod	750	0.04
3mm Hanger Rod	1000	0.06
3mm Hanger Rod	1500	0.08

*Colour: RAL 9016/ Traffic white

COMPONENTS

Gypframe Main T Grid sections

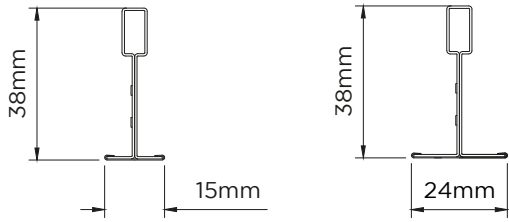

Gypframe Main T Grid
15mm

Gypframe Main T Grid
24mm

Gypframe Cross T Grid sections

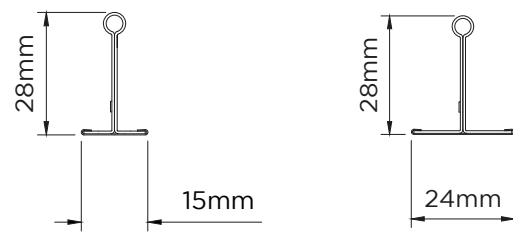

Gypframe Cross T Grid
15mm

Gypframe Cross T Grid
24mm

Gypframe T Angles

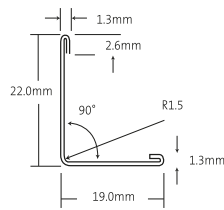

Gypframe T Wall Angle

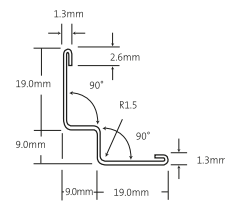

Gypframe T Shadow Angle

HEALTH & SAFETY

1. IDENTIFICATION OF THE SUBSTANCES/PREPARATION AND COMPANY

24mm T Grid Sections
 15mm T Grid Sections
 Wall and Shadow Angles
 Adjustable Hangers

Supplier Saint-Gobain Gyproc Emirates Industries LLC
 ICAD 1, Mussafah
 Abu Dhabi
 United Arab Emirates
 P.O. Box 38983
 Free Phone: +971 800 GYPROC (497762)
 Email: gyproc-me@saint-gobain.com

Recommended uses: In conjunction with Gyproc plasterboards to form internal walls and ceiling systems, linings and encasements.

2. Composition / Information on ingredients

General composition: Mild steel sections coated by zinc electrolytic process or hot dip galvanised process. The sections may have a protective film of a roll forming hydrocarbon lubricant or a residue of cutting fluid. Minimum zinc coating of base metal of T grids is 19µ.

3. Hazards identification

THE MOST IMPORTANT HAZARDS ARE:

These products are not classified as dangerous according to CLP. CLP is the law that applies to suppliers of dangerous chemicals. Its purpose is to protect people and the environment from the effects of those chemicals by requiring suppliers to provide information about the dangers and to package them safely.

There is a risk of cuts and abrasions from sharp edges and ends when handling metal sections and in use where they have been fitted to floors or walls and are exposed, prior to fixing plasterboard.

There is also a risk when cutting the banding due to the release of tension and the potential movement of material. Repeated contact with sheet metal coatings may cause skin irritation. During power cutting, grinding or drilling, irritant fumes or dust may be produced which can cause metal fume fever.

4. First aid measures

Eye contact P305 + P351 + P338 - IF IN EYES: Rinse cautiously with water for several minutes. Remove contact lenses, if present and easy to do. Continue rinsing.
 P337 + P313 - If eye irritation persists: Get medical advice/attention.

Skin contact P264 - Wash hands thoroughly after handling.

Ingestion Not applicable.

Inhalation Not applicable.

General Get medical attention if any symptoms persist.

5. Fire fighting measures

The products do not pose a fire hazard. However, the protective coating/lubricant, packaging banding or sponge rubber elements may be combustible and emit hazardous fumes.

Suitable extinguishing media - foam, carbon dioxide, dry powder.

6. Accidental release measures

Product discarded in an unaltered form is classified as a non-hazardous waste.

7. Handling and storage

Mechanical handling- The dimensions of the pallet vary depending upon the product size. To avoid potentially overloading a lift truck, it is important that any effect on load centres is considered. The nominal weight of each palletised load is given on the delivery note.

Manual handling - Metal sections are supplied in a variety of lengths and widths and the weight of different sections varies. Do not use the banding or straps for lifting. Carefully consider the manual handling risks before lifting sections of metal. Appropriate cut-resistant PPE should be used when handling metal sections.

Storage - Store on pallets supplied and in dry conditions. To maintain stability, place pallets on firm level ground and ensure that stacks are both level and vertical. Stack height should not exceed twice the width of the pack. Banding should only be removed at ground level.

Use - Caution: as with all cut metal products, there is risk from sharp corners or edges. Appropriate cut-resistant PPE should be used when handling metal sections. Avoid prolonged and repeated contact with skin and wear protective clothing when handling metal sections (see Section 8).

When the banding is cut it may spring back as tension is released and the pack of material may become unstable. Appropriate PPE (including eye protection to BS EN 166) should be worn.

Metal sections are not designed to support body weight; fixers must work from an independent support system.

8. Exposure control/ personal protection

Respiratory P284 - Use only in well-ventilated areas. Wear eye / face protection. Face masks to EN 149 FFP2.
 Skin P303 - Wear suitable protective clothing.
 Eye P305 / P313 - Wear eye / face protection. Eye protection to BS EN 166.

9. Physical and chemical properties

Appearance Metal sections in various lengths, thickness and formation.
 Odour Paraffin/oil (protective coating).

10. Stability and reactivity

Stable under normal conditions but when subjected to high temperatures fumes are produced.

HEALTH & SAFETY

11. Toxicology information

- Inhalation** Dry grinding or machining may produce dust of the same composition as the coating and base metal. Flame cutting may produce fumes containing oxides of zinc and iron, and also breakdown products of protective coating. Potential effects health include metal fume fever, a condition similar to influenza.
- Skin contact** Prolonged and repeated contact may cause irritation
- Eye contact** None in normal use.
- Ingestion** Not applicable.

12. Ecological information

Stable product with no known adverse environmental effects.

13. Recycling

Gypframe Metal components contain recycled content and can contribute to LEED NC v2.2 Credit MRc4: Recycled Content.

14. Disposal consideration

Dispose at an authorised metal recycling facility in accordance with local waste management licensing regulations.

15. Transport information

Not classified as hazardous for transportation.

16. Regulatory information

Not classified under the CLP regulations.

17. Other information

Note to User:

This Product Data Sheet does not constitute a workplace risk assessment for COSHH.

There are a number of situations where the approach to manual handling of Gyproc products should be considered. For further guidance, please refer to the Manual Handling Section of the WHITE BOOK, or contact Gyproc technical department.

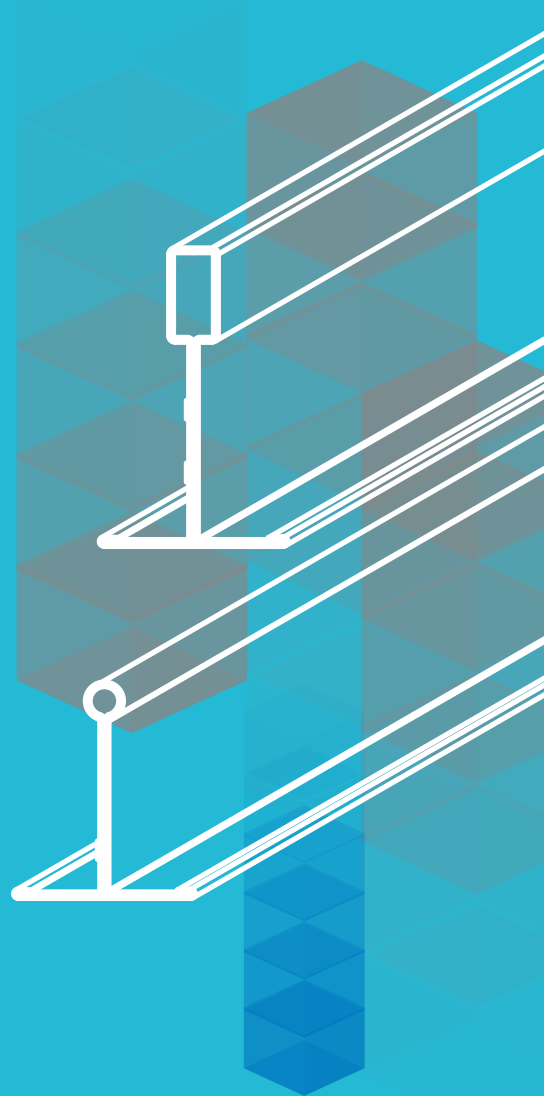

Saint-Gobain Gyproc Middle East FZE
P.O.Box 261107
Dubai, UAE
Tel: +971 (4) 4502300
Fax: +971 (4) 4468701

Saint-Gobain Gyproc Emirates Industries LLC
P.O.Box 38983
ICAD 1, Mussafah
Abu Dhabi, UAE

www.gyproc.ae

First Edition
Literature Code: 0317-DS-001

